

ARDEN & WAY

BLOCK MANAGEMENT & LETTINGS



1 Kensington House Manor Road

, Hayling Island, PO11 0EZ

£350,000

Arden & Way are pleased to present to the sales market this beautifully presented ground floor apartment offering generous and well-designed living space, set within a modern gated development just moments from West Town's shops, amenities, and within easy walking distance of the beach.

Built in 2007, the property features a bright and spacious open-plan living/dining room, enhanced by French doors that open directly onto a private, south-facing decking area—perfect for relaxing or entertaining. This outdoor space is complemented by an electric awning, providing shade and comfort throughout the day.

The kitchen is modern and thoughtfully fitted, offering ample storage and workspace, ideal for everyday living. There are two well-proportioned double bedrooms, including a master bedroom with a contemporary en suite shower room. A second stylish family bathroom serves the remaining bedroom and guests.

Additional benefits include gas central heating, double glazing, a private lock-up storage unit, and one wide allocated parking space within the residents' car park. The development also benefits from secure gated entry for added peace of mind.

Early viewing is highly recommended to fully appreciate the quality, location, and lifestyle this property has to offer. For more information or to arrange a viewing please contact Arden & Way!

Viewing

Please contact our Arden & Way Office on 02392 460 899 if you wish to arrange a viewing appointment for this property or require further information.



2



2



1



B

Floor Plan

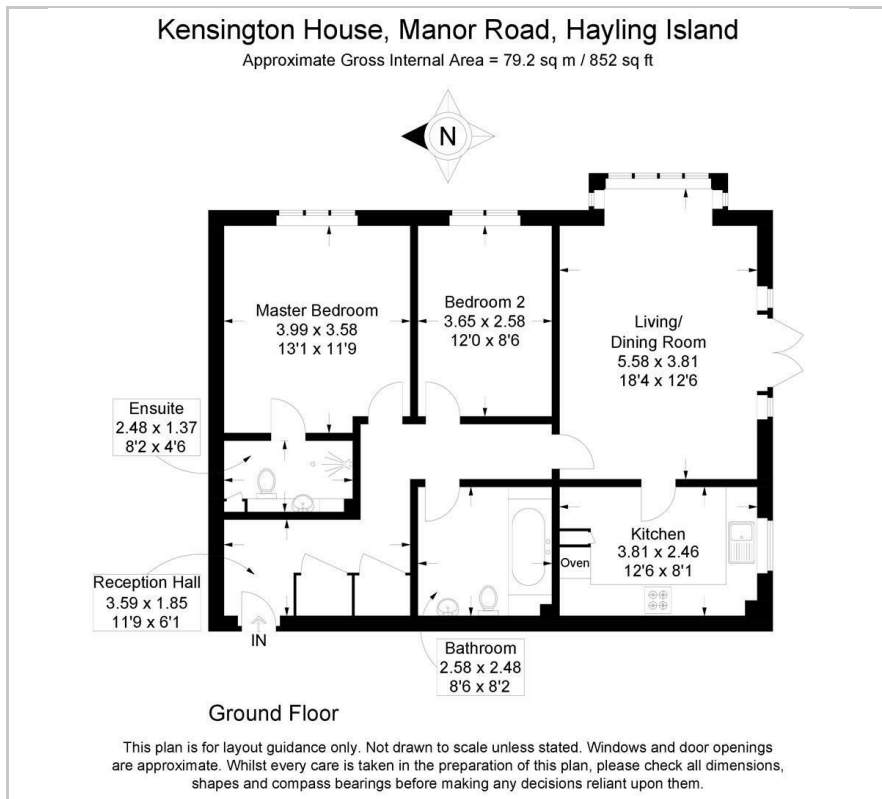

Area Map



Energy Efficiency Graph

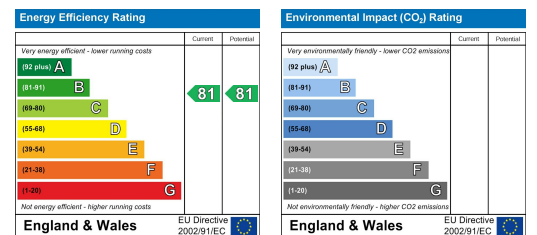

These particulars, whilst believed to be accurate are set out as a general outline only for guidance and do not constitute any part of an offer or contract. Intending purchasers should not rely on them as statements of representation of fact, but must satisfy themselves by inspection or otherwise as to their accuracy. No person in this firm's employment has the authority to make or give any representation or warranty in respect of the property.

120 Elm Grove, Hayling Island, Hampshire, PO11 9EH

Tel: 02392 460 899

Email: info@ardenway.co.uk

www.ardenway.co.uk